

# Christmas Concert - 2022 Programme

HSO Sleigh Ride

All **Once in Royal David's City** (pg 260)  
(V1 solo, V2, V5, V6 with descant)

HCS, HSO, Schools **Nativity Carol** (pg 62)

Schools Group 1

All **O Little Town of Bethlehem** (pg 234) all verses

Schools Group 2

Beati & Schools **Cantemus a Maria**

Schools Group 3

All Schools / HSO / HCS **Away in a Manger** (\*\*)  
V1&2 children, sing V3 only

All **Good King Wenceslas** (NB do not use the version in white carol books as the harmony is wrong, either use green carol book if you have one or print off the pdf which has been emailed)

## INTERVAL

**Concert Dress** : Men - plain coloured long sleeved shirts (bright colours if possible) with black bow tie ( no jackets)

Ladies - plain bright coloured long sleeved (or  $\frac{3}{4}$  sleeve) shirt style blouses. (no scarves)

**Smart black trousers (or ankle length black skirts) for everyone and choir folders!**

Tinsel etc optional extras if you wish! Antlers allowed only on back row !

All **Hark the Herald Angels sing** (pg 107)  
(all verses, V3 with descant)

HCS & HSO **The Three Kings** (pg 346)

HSO, HCS & Schools **Reindeer on the Roof** (\*\*)

HSO and Schools **The Polar Express**

All Schools / HSO / HCS

**Jingle Bells** (pg 73)  
**We Wish you a Merry Christmas**  
(pg 164 but sung in unison)

All **O Come All Ye Faithful** (pg226)  
(V1, V2, & V6 - V6 with descant)

**Notes:-** sing items in bold!  
(\*\*) indicates separate sheet

# Christmas Concert - Timings etc

## Rehearsals

- By 2.50 pm HCS arrive, leave coats etc in the restaurant adjacent to Hall D - see picture
- 3.00 pm Assemble in bar area where a line up will take place
- 3.05 pm HCS walk in formation to stage
- 3.20 pm HCS rehearse with HSO
- 3.45 pm HCS rehearse with HSO & children
- 4.55 pm HSO & HCS leave auditorium (time for quick rest, loo etc)

## Evening arrangements

- By 5.30 pm Leave coats etc in restaurant
- 5.40 To bar area, line up & walk to auditorium
- 6.00 pm Concert starts
- 7.00 pm Interval
- 7.30 pm back on stage
- 8.40 pm concert ends (approx.)

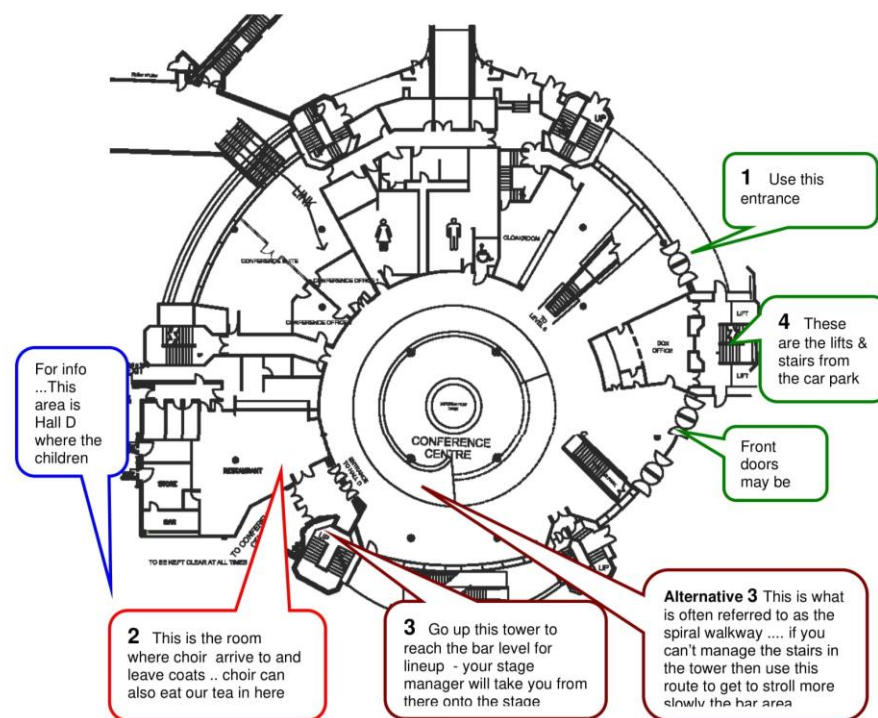

**Parking** :- Please be aware that normal (expensive!) car park fees apply during the day for the underground pay & display car park. There may be a discounted fee in the evening from 5.00pm. Alternative is (limited) on disc street parking or Jubilee car park. Suggest parking on street then moving car at break time or car share to share cost of parking?

**Security:** There will be bag checks on all entrances (via door or lift from carpark) from 5pm in the evening. If you need to bring in a large bag please do so in the afternoon as you may not be able to bring it in after 5pm